

VERSIONS

- Type **A**: without thread coating
- Type **GPC**: with thread coating

Zinc-plated steel, blue passivated **ST**  
 AISI 303 stainless steel **NI**

Thread coating (Type GPC)  
 Precote 5

- white
- Operating temperature -60 °C to +150 °C

INFORMATION

Threaded plugs DIN 906 are used to close bore holes with cylindrical internal thread. The tightness depends on the medium, pressure, temperature and material pairing. The type GPC with thread coating provides a higher degree of safety.

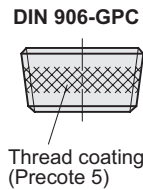
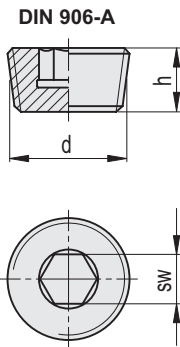
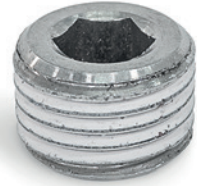

Thread coating (Precote 5)

DIN 906-ST-A

| Code     | Description          | d       | h  | sw | ⚖   |
|----------|----------------------|---------|----|----|-----|
| GN.22641 | DIN 906-ST-M6X1-A    | M6x1    | 6  | 3  | 1   |
| GN.22643 | DIN 906-ST-M8X1-A    | M8x1    | 8  | 4  | 2   |
| GN.22645 | DIN 906-ST-M10X1-A   | M10x1   | 8  | 5  | 3   |
| GN.22647 | DIN 906-ST-M12X1,5-A | M12x1.5 | 10 | 6  | 6   |
| GN.22649 | DIN 906-ST-M14X1,5-A | M14x1.5 | 10 | 7  | 8   |
| GN.22651 | DIN 906-ST-M16X1,5-A | M16x1.5 | 10 | 8  | 10  |
| GN.22653 | DIN 906-ST-M18X1,5-A | M18x1.5 | 10 | 8  | 14  |
| GN.22655 | DIN 906-ST-M20X1,5-A | M20x1.5 | 10 | 10 | 17  |
| GN.22657 | DIN 906-ST-M22X1,5-A | M22x1.5 | 10 | 10 | 22  |
| GN.22659 | DIN 906-ST-M24X1,5-A | M24x1.5 | 12 | 12 | 30  |
| GN.22661 | DIN 906-ST-M26X1,5-A | M26x1.5 | 12 | 12 | 37  |
| GN.22663 | DIN 906-ST-M30X1,5-A | M30x1.5 | 12 | 17 | 44  |
| GN.22665 | DIN 906-ST-M36X1,5-A | M36x1.5 | 15 | 19 | 86  |
| GN.22667 | DIN 906-ST-M42X1,5-A | M42x1.5 | 18 | 22 | 143 |
| GN.22669 | DIN 906-ST-M45X1,5-A | M45x1.5 | 18 | 22 | 163 |
| GN.22671 | DIN 906-ST-M48X1,5-A | M48x1.5 | 20 | 24 | 210 |
| GN.22685 | DIN 906-ST-R1/8-A    | R 1/8   | 8  | 5  | 4   |
| GN.22683 | DIN 906-ST-R1/4-A    | R 1/4   | 10 | 7  | 7   |
| GN.22695 | DIN 906-ST-R3/8-A    | R 3/8   | 10 | 8  | 12  |
| GN.22681 | DIN 906-ST-R1/2-A    | R 1/2   | 10 | 10 | 19  |
| GN.22693 | DIN 906-ST-R3/4-A    | R 3/4   | 12 | 12 | 38  |
| GN.22691 | DIN 906-ST-R1-A      | R 1     | 12 | 17 | 57  |
| GN.22689 | DIN 906-ST-R11/4-A   | R 1 1/4 | 18 | 22 | 134 |
| GN.22687 | DIN 906-ST-R11/2-A   | R 1 1/2 | 20 | 24 | 199 |

DIN 906-ST-GPC

| Code     | Description            | d       | h  | sw | ⚖   |
|----------|------------------------|---------|----|----|-----|
| GN.22642 | DIN 906-ST-M6X1-GPC    | M6x1    | 6  | 3  | 1   |
| GN.22644 | DIN 906-ST-M8X1-GPC    | M8x1    | 8  | 4  | 2   |
| GN.22646 | DIN 906-ST-M10X1-GPC   | M10x1   | 8  | 5  | 3   |
| GN.22648 | DIN 906-ST-M12X1,5-GPC | M12x1.5 | 10 | 6  | 6   |
| GN.22650 | DIN 906-ST-M14X1,5-GPC | M14x1.5 | 10 | 7  | 8   |
| GN.22652 | DIN 906-ST-M16X1,5-GPC | M16x1.5 | 10 | 8  | 10  |
| GN.22654 | DIN 906-ST-M18X1,5-GPC | M18x1.5 | 10 | 8  | 14  |
| GN.22656 | DIN 906-ST-M20X1,5-GPC | M20x1.5 | 10 | 10 | 17  |
| GN.22658 | DIN 906-ST-M22X1,5-GPC | M22x1.5 | 10 | 10 | 22  |
| GN.22660 | DIN 906-ST-M24X1,5-GPC | M24x1.5 | 12 | 12 | 30  |
| GN.22662 | DIN 906-ST-M26X1,5-GPC | M26x1.5 | 12 | 12 | 37  |
| GN.22664 | DIN 906-ST-M30X1,5-GPC | M30x1.5 | 12 | 17 | 44  |
| GN.22666 | DIN 906-ST-M36X1,5-GPC | M36x1.5 | 15 | 19 | 86  |
| GN.22668 | DIN 906-ST-M42X1,5-GPC | M42x1.5 | 18 | 22 | 143 |
| GN.22670 | DIN 906-ST-M45X1,5-GPC | M45x1.5 | 18 | 22 | 163 |
| GN.22672 | DIN 906-ST-M48X1,5-GPC | M48x1.5 | 20 | 24 | 210 |
| GN.22686 | DIN 906-ST-R1/8-GPC    | R 1/8   | 8  | 5  | 4   |
| GN.22684 | DIN 906-ST-R1/4-GPC    | R 1/4   | 10 | 7  | 7   |
| GN.22696 | DIN 906-ST-R3/8-GPC    | R 3/8   | 10 | 8  | 12  |
| GN.22682 | DIN 906-ST-R1/2-GPC    | R 1/2   | 10 | 10 | 19  |
| GN.22694 | DIN 906-ST-R3/4-GPC    | R 3/4   | 12 | 12 | 38  |
| GN.22692 | DIN 906-ST-R1-GPC      | R 1     | 12 | 17 | 57  |
| GN.22690 | DIN 906-ST-R11/4-GPC   | R 1 1/4 | 18 | 22 | 134 |
| GN.22688 | DIN 906-ST-R11/2-GPC   | R 1 1/2 | 20 | 24 | 199 |

DIN 906-NI-A



| Code     | Description          | d       | h  | sw | ⚖  |
|----------|----------------------|---------|----|----|----|
| GN.22601 | DIN 906-NI-M8X1-A    | M8x1    | 8  | 4  | 2  |
| GN.22603 | DIN 906-NI-M10X1-A   | M10x1   | 8  | 5  | 3  |
| GN.22605 | DIN 906-NI-M12X1,5-A | M12x1.5 | 10 | 6  | 6  |
| GN.22607 | DIN 906-NI-M14X1,5-A | M14x1.5 | 10 | 7  | 8  |
| GN.22609 | DIN 906-NI-M16X1,5-A | M16x1.5 | 10 | 8  | 10 |
| GN.22611 | DIN 906-NI-M18X1,5-A | M18x1.5 | 10 | 8  | 14 |
| GN.22613 | DIN 906-NI-M20X1,5-A | M20x1.5 | 10 | 10 | 17 |
| GN.22615 | DIN 906-NI-M22X1,5-A | M22x1.5 | 10 | 10 | 22 |
| GN.22617 | DIN 906-NI-M24X1,5-A | M24x1.5 | 12 | 12 | 30 |
| GN.22625 | DIN 906-NI-R1/8-A    | R 1/8   | 8  | 5  | 4  |
| GN.22623 | DIN 906-NI-R1/4-A    | R 1/4   | 10 | 7  | 7  |
| GN.22631 | DIN 906-NI-R3/8-A    | R 3/8   | 10 | 8  | 12 |
| GN.22621 | DIN 906-NI-R1/2-A    | R 1/2   | 10 | 10 | 19 |
| GN.22629 | DIN 906-NI-R3/4-A    | R 3/4   | 12 | 12 | 39 |
| GN.22627 | DIN 906-NI-R1-A      | R 1     | 12 | 17 | 57 |

DIN 906-NI-GPC



| Code     | Description            | d       | h  | sw | ⚖  |
|----------|------------------------|---------|----|----|----|
| GN.22602 | DIN 906-NI-M8X1-GPC    | M8x1    | 8  | 4  | 2  |
| GN.22604 | DIN 906-NI-M10X1-GPC   | M10x1   | 8  | 5  | 3  |
| GN.22606 | DIN 906-NI-M12X1,5-GPC | M12x1.5 | 10 | 6  | 6  |
| GN.22608 | DIN 906-NI-M14X1,5-GPC | M14x1.5 | 10 | 7  | 8  |
| GN.22610 | DIN 906-NI-M16X1,5-GPC | M16x1.5 | 10 | 8  | 10 |
| GN.22612 | DIN 906-NI-M18X1,5-GPC | M18x1.5 | 10 | 8  | 14 |
| GN.22614 | DIN 906-NI-M20X1,5-GPC | M20x1.5 | 10 | 10 | 17 |
| GN.22616 | DIN 906-NI-M22X1,5-GPC | M22x1.5 | 10 | 10 | 22 |
| GN.22618 | DIN 906-NI-M24X1,5-GPC | M24x1.5 | 12 | 12 | 30 |
| GN.22626 | DIN 906-NI-R1/8-GPC    | R 1/8   | 8  | 5  | 4  |
| GN.22624 | DIN 906-NI-R1/4-GPC    | R 1/4   | 10 | 7  | 7  |
| GN.22632 | DIN 906-NI-R3/8-GPC    | R 3/8   | 10 | 8  | 12 |
| GN.22622 | DIN 906-NI-R1/2-GPC    | R 1/2   | 10 | 10 | 19 |
| GN.22630 | DIN 906-NI-R3/4-GPC    | R 3/4   | 12 | 12 | 39 |
| GN.22628 | DIN 906-NI-R1-GPC      | R 1     | 12 | 17 | 57 |